

HANDCASE

TI MANAGER USER MANUAL

This manual is intuitive as our software, is enough to observe the images to understand as to use best of and the more efficient form. The screens follow the logical order of the presentation them tools in the interface of each software.

Descriptive

Suite of 6 tools integrated into a single interface to organize the work of managers of IT. You can organize all the work of resource management technology area by the company, and offers controls that range from the update until the purchase of hardware through the contracting of services. It also offers organization of requests from other areas to services, maintenance and anything that involves the organization of services for the area of IT with other areas of the company. It offers tools Requests, Manager, Updates, Reports, Departments and Costs.

1.0 - PALM OS 3.5 or superior (ram 86 KB)

Install

Just unpacking the zip on the desktop and give a double click the file **IT Manager.prc** the tool installation of your Palm will open showing the file being synchronized, synchronize and ready.



You recognize by the icon on the side.

Initial Interface



Here you choose the tool you want.

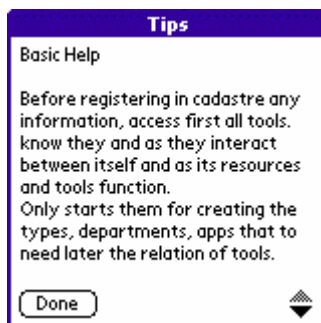

Here you can, using this menu copy and paste information that can be copied from Memopad, Address and DateBook of the Palm.

